

Product type



Models
S66, S76
T66, T76

Version
05-2021
Rev. 1.0

SAFETY FIRST!

IMPORTANT

- This document **DOES NOT** replace the Operation & Maintenance Manual.
- You must read **ALL** safety and other instructions from the Operation & Maintenance Manual before operating, transporting or servicing this machine.



MAIN MACHINE SPECIFICATIONS

	UNIT	S66	S76	T66	T76
Operating weight (with bucket, operator and full fuel tank)	kg	3271	2722	4296	5051
Shipping weight	kg	2939	1367	3712	4394
Engine power (ISO 14396)	kW @ rpm	54.5 @ 2600	54.5 @ 2600	54.5 @ 2600	54.5 @ 2600
Tipping load (ISO 14397-1)	kg	2359	2722	3175	4050
Rated operating capacity (ISO 14397-1)	kg	1184	1367	1115	1426
Pump capacity (std/high)	l/min	66.5/101.8	88.1/114.7	66.5/101.8	88.1/114.7
Travel speed (low/high)	km/h	11.8/17.3	10.9/19.0	10.4/16.4	14.8/17.2
Lift breakout force	daN	2200	2608	2269	3544
Tilt breakout force	daN	2440	2654	2179	2871
Length with standard bucket	mm	3427	3737	3427	3737
Width over standard bucket	mm	1727	1880	1880	2032
Height with operator cab	mm	2045	2079	2045	2079
Height to bucket hinge pin	mm	3048	3259	3048	3259
Wheelbase/ground contact length	mm	1133	1227	1378	1505

CONTROL ELEMENTS

¹ if equipped



INSTRUMENT PANEL OVERVIEW

- Cab light
- Hands-free microphone
- Touch display/radio input ports
- Storage compartment
- Standard display Touch display¹
- HVAC controls¹
- Left control panel
- Right control panel

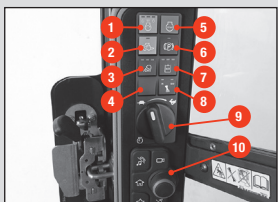

LEFT CONSOLE

- Windshield wiper¹
- Windshield washer¹
- Dual direction bucket positioning¹
- Auto ride control¹
- Power Bob-Tach wedges up¹
- Power Bob-Tach wedges down¹
- Not used
- Reversing fan¹
- Accessory switches¹



RIGHT CONSOLE

- Run / Start
- Operate
- Lights
- Not used
- Stop
- Parking brake
- Auxiliary hydraulics
- Selectable joystick controls (SJC)¹
- Engine speed control
- Jog shuttle



JOG SHUTTLE

- Rear view camera
- Gauges (Press to change display view to the GAUGES screen)
- Back or Volume/navigation (with touch display)¹
- Not used or Audio/phone (with touch display)¹
- Rotary knob
- Not used or Favorite (with touch display)¹

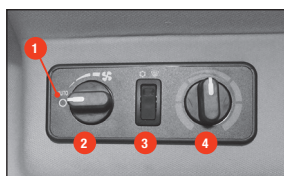

HVAC CONTROLS

- Auto fan position¹
- Fan motor speed
- Air conditioning/defrost switch¹
- Temperature control

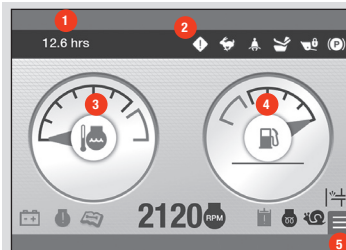

STANDARD DISPLAY (EXCERPT)

- Hourmeter
- General warning indicator
- Engine coolant temperature gauge
- Fuel gauge
- Navigation handle



TOUCH DISPLAY (EXCERPT)

- Hourmeter
- Status indicators
- Engine oil pressure gauge
- Hydraulic charge pressure gauge
- Fuel gauge
- Hydraulic fluid temperature gauge
- Engine coolant temperature gauge



ENGINE START/STOP

Engine start/stop can either be done with buttons on the right console or rotary key start switch¹. For details how to start/stop the engine, please refer to the Operation & Maintenance Manual.



- Rotary key start switch¹
 - Engine stop
 - Engine run / preheat
 - Engine start

JOYSTICK CONTROLS

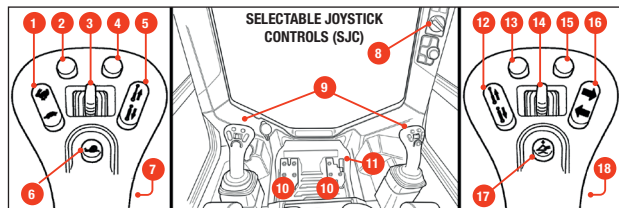
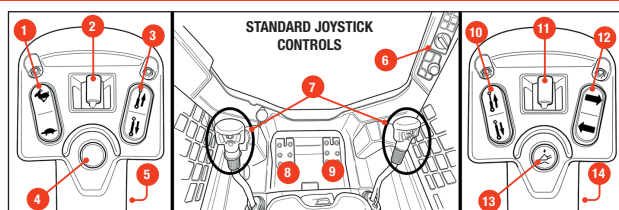

STANDARD JOYSTICK CONTROLS

- 1 Two-speed control¹
- 2 Rear auxiliary hydraulics¹/ attachment function control
- 3 Attachment function control
- 4 Not used
- 5 Front horn
- 6 Engine speed control
- 7 Steering levers
- 8 Lift arm pedal
- 9 Tilt pedal
- 10 Attachment function control
- 11 Front auxiliary hydraulics
- 12 Turn signals¹
- 13 Float control
- 14 Continuous flow control for auxiliary hydraulics

SELECTABLE JOYSTICK CONTROLS

- 1 Two-speed control¹/ speed management
- 2 Steering drift compensation
- 3 Rear auxiliary hydraulics¹/ attachment function control
- 4 Steering drift compensation
- 5 Attachment function control
- 6 Speed management
- 7 Front horn
- 8 Engine speed control (hand)
- 9 Joysticks
- 10 Footrests
- 11 Engine speed control (foot)
- 12 Attachment function control
- 13 Not used
- 14 Front auxiliary hydraulics
- 15 Not used
- 16 Turn signals¹
- 17 Float control
- 18 Continuous flow control for auxiliary hydraulics

KEY SAFETY INSTRUCTIONS

GENERAL SAFETY INSTRUCTIONS

- ▶ **Check Operation & Maintenance Manual for full safety instructions**
Make sure no bystanders are in the work area. Never carry riders.
- ▶ **Ensure daily inspection and maintenance**
See below for more information.
- ▶ **Do not exceed rated lift capacity**
Always check lift capacity chart in Operation & Maintenance Manual. Excessive load can cause tipping or loss of control. Avoid tipping.
- ▶ **Seat belt and seat bar restraint**
Always fasten seat belt snugly, use the seat bar and keep feet on foot pedals or footrests.
- ▶ **Never use attachments or buckets which are not approved by Bobcat Company**
Before any use, ensure that the attachment is properly locked.

SEAT BAR RESTRAINT SYSTEM

- ▶ When the seat bar ① is raised, hydraulic and traction system functions are locked and will not operate.



TRANSPORT/TIE-DOWN

- ▶ Use transport and towing vehicle of adequate length and capacity.
- ▶ Secure parking brakes and block wheels of transport vehicle.
- ▶ Use and align metal loading ramps with slip resistant surface.
- ▶ Drive backward onto the transport vehicle.
- ▶ Fasten holdown chains to tie down points.
- ▶ Tighten chains with chain binders.

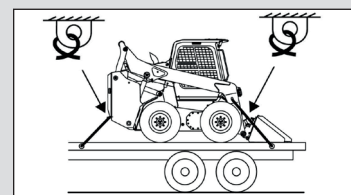

LIFT ARM SUPPORT

- ▶ Never go under or reach under lift arms or lift cylinder without an approved lift arm support installed.

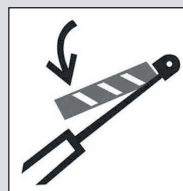

DAILY INSPECTION AND MAINTENANCE

¹ if equipped

AROUND MACHINE

- ▶ Check canopy/cab condition and mounting hardware
- ▶ Check safety signs (decals)
- ▶ Check attachment, quick coupler, tires or tracks
- ▶ Grease all pivot points

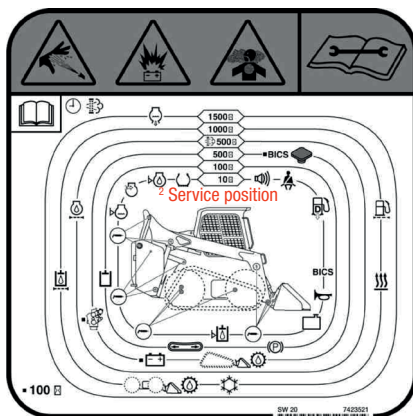

IN CANOPY/CAB

- ▶ Check seat belt, retractors, safety bar
- ▶ Check motion alarm, horn and rear-view camera¹
- ▶ Check indicators and lights
- ▶ Check cab filters and HVAC filters



FILTERS

Fuel filter



Fuel pre-filter

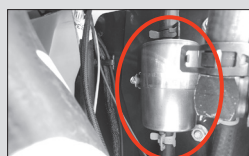

Engine air filter

Pull the tab to remove cover

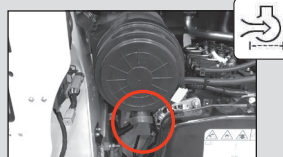

Remove outer and inner filters

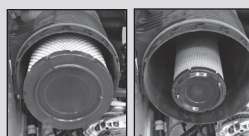

FLUID LEVELS

Engine oil

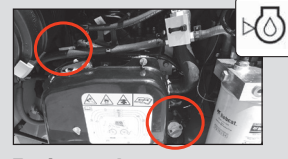

Engine coolant

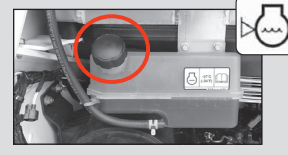

Hydraulic fluid

Machine must be in service position²

- ▶ For more details, please refer to the Operation & Maintenance Manual.

